

Preparation of Opening

Calculate the correct opening size. Make sure the opening is square and perpendicular. Lay bitumen expansion material along base of opening. Secure expansion foam to jambs and head. All four sides of the opening should now be covered in expansion material. Bitumen is necessary on the base to take the weight of the glass block wall.

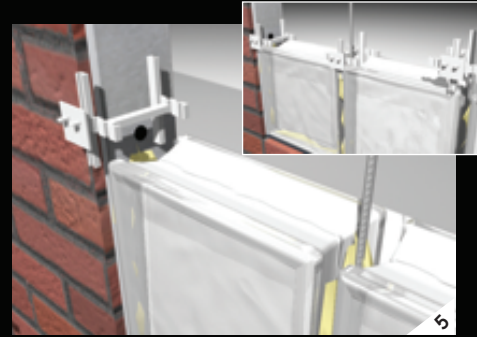

Set out dry the first row of glass blocks to ensure opening size is correct. Mark accurately and drill oversized holes in between the blocks, vertically and horizontally where rods will be positioned. Fill holes with silicone and fit vertical bars in place.



Laying First Course

Mix Colmef Vetromix glass block mortar following instructions on reverse of bag. The mix should be a semi-dry consistency (slump 1 or less). Lay down a bed of mortar.

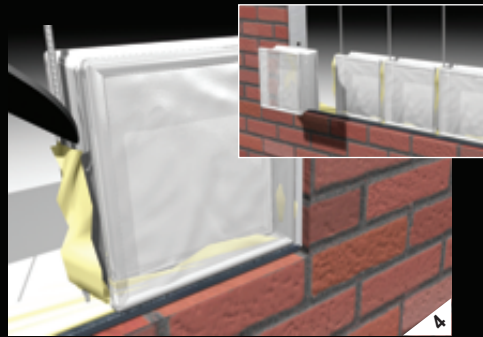

Fit first block and tamp down gently, fit second block and repeat. Ensure there is enough mortar between the blocks and the base to create sufficient adhesion, compact the vertical mortar joint using a wooden instrument. Spacer pegs are required between base and first row of blocks.

Building the Panel

After the first row is completed insert spacer pegs in between blocks and between the block and aperture they can be formed in to a T shape, by snapping or cutting the legs of the spacer peg. This prevents steel rods from touching glass.

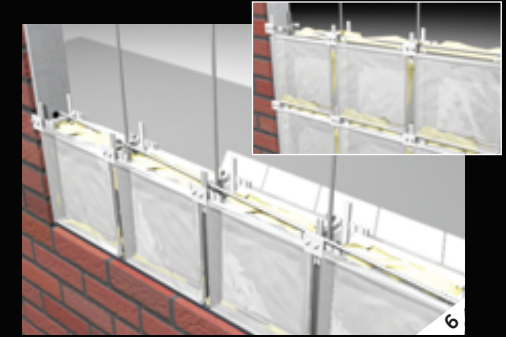

Lay half the quantity of mortar and fix the horizontal rod in position, not forgetting to put silicone in the holes, and then cover over the rod with remainder of mortar. Rods have to be positioned every row vertically and horizontally. Fit next row, remembering to check vertical and horizontal alignment.

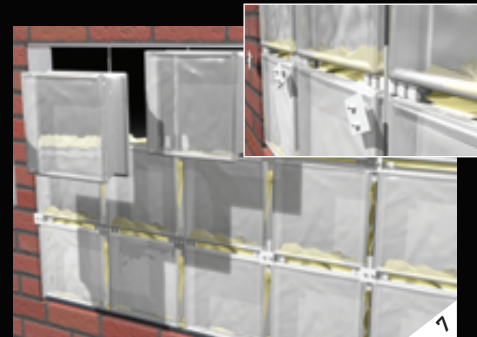

Finishing the Glass Block Panel

When the wall has set, snap off spacer tabs and grout all joints with diluted Colmef Vetromix mortar.

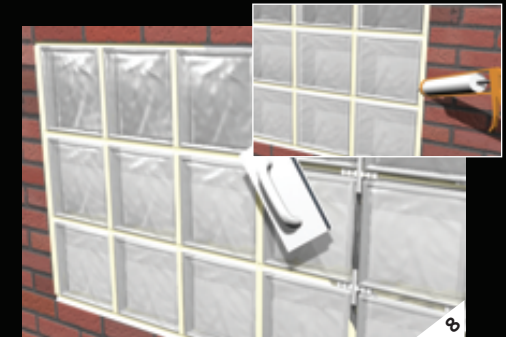

Sealing and Weatherproofing

Ensure that all excess residue mortar is cleared and mastic around perimeter of expansion foam to create a weatherproof seal using the Rods and Mortar expansion joint sealer. When installing fire rated glass blocks, Fire Stop mastic should be used.

Initial Clean and After Care Maintenance

Do not clean with any acidic products. Periodic cleaning is required. The best product is clean water. Buff up with a chamois leather and polish each block with a soft, lint free cloth using good old elbow grease.

Note: Clean face of block as work proceeds.

The glass block installer should have left the glass block wall in a clean, unblemished condition, requiring only periodical cleaning to maintain an excellent appearance. However, there may be a residue of cement on the glass surface left from mortar/tiling grout identified by whitish bloom when dry. This may be removed by use of proprietary cement stain remover.

Hydrofluoric Acid or Derivatives Must Not Be Used

Paint or cement may be removed by a blade, taking care not to scratch the surface of the glass.