

PLAN

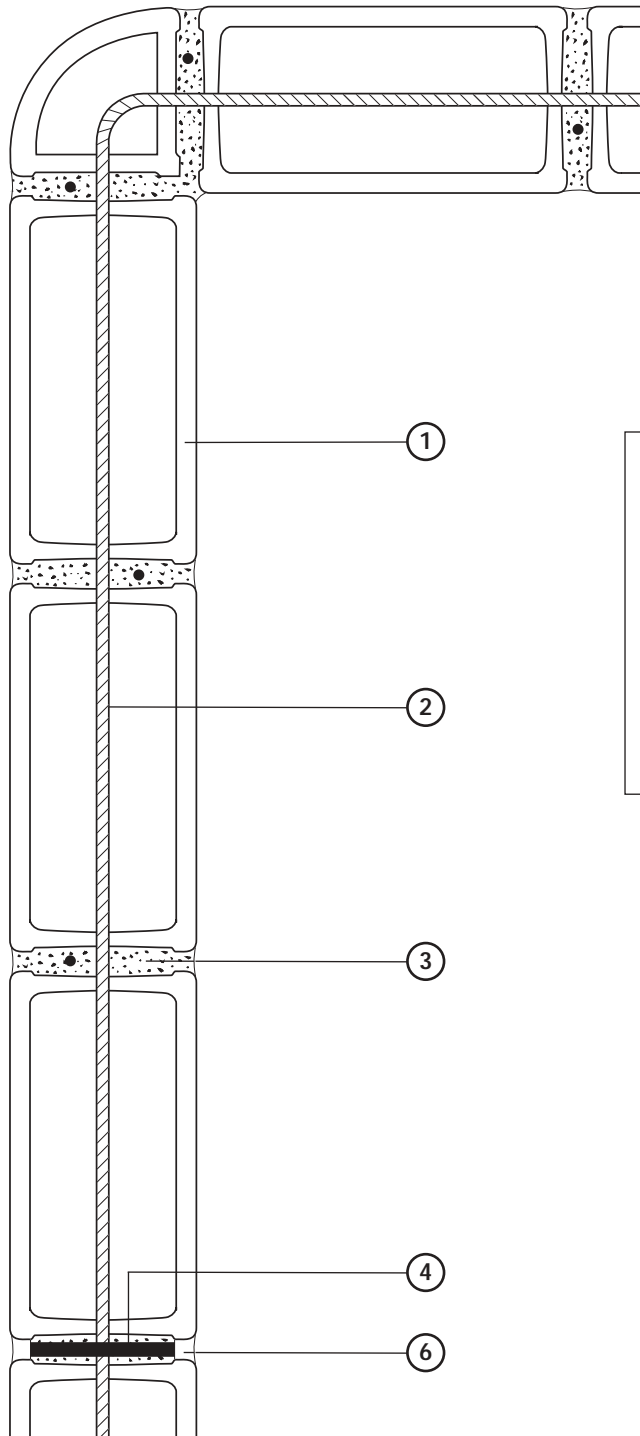

KEY :

- ① Glass block
- ② Reinforcement Rod
- ③ Colmef Vetromix Mortar (also for grout finishing)
- ④ Expansion material
- ⑥ Silicon Sealant



CORNER BLOCK

Glass Block Technology Limited,
170 Lodge Lane, Hyde, Cheshire SK14 4LB
Tel : 0161 612 6893 Fax : 0161 285 1503

DRAWING TITLE :

**FITTING A GLASS BLOCK WALL IN RODS
& MORTAR USING 90° CORNER BLOCKS**

NOTES

1. Drawing not to scale. For information purposes only.

This drawing may not be reproduced or made use of unless expressly agreed by Glass Block Technology Limited.

DRAWING No.

GBT/0023