

LA ROCHERE G60/F15 FIRE GLASS BLOCK

FIRE RATING

La Rochere 190x190x80 glass blocks when installed in accordance with Glass Block Technology's Rods and mortar system achieve certification for 1 hour fire integrity and a 15 minute thermal isolation.

This higher fire rating is achieved due to the purity of La Rochere glass blocks that will only fuse at a higher temperature of around 1550°C.

Fire resistance is concerned with four criteria :

- (a) Mechanical Resistance - the glass block wall must stay upright without too much damage following testing**
- (b) Thermal isolation**
- (c) Imperviousness against blaze**
- (d) No flammable emission during testing.**

These tests are recorded in 15 minute increments.

La Rochere fire certificates available on request.

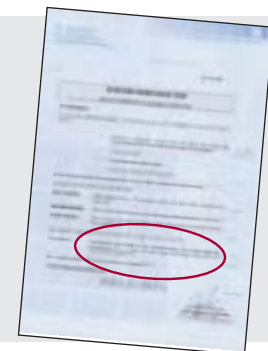

DEFINITION :

FIRE INTEGRITY (G-CATEGORY GLAZING)

The glass block wall must pass Test (a) above.

THERMAL ISOLATION (F-CATEGORY GLAZING)

The glass block wall must pass all four of the criteria above.

Glass blocks under test conditions



PERFORMANCE

Fire Integrity (G-category glazing) : 60 minutes

Thermal Isolation (F-category glazing) : 15 minutes

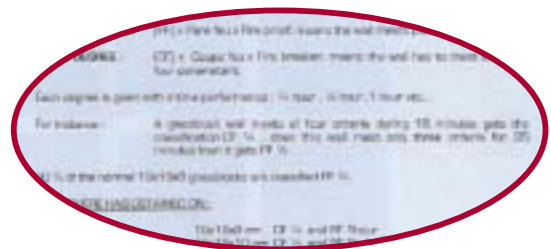

HOW THE PANEL SHOULD BE FITTED

Glass Block Technology rods and mortar fitting instructions are based on how the panel was tested. i.e: a single rod in each direction, perimeter expansion fibre etc.

For fitting instructions, see 'How to Install with Rods and Mortar'. For architectural details and possible connections see data sheets GBT/0001 and GBT/0002 or go to www.glassblocks.co.uk/datasheets

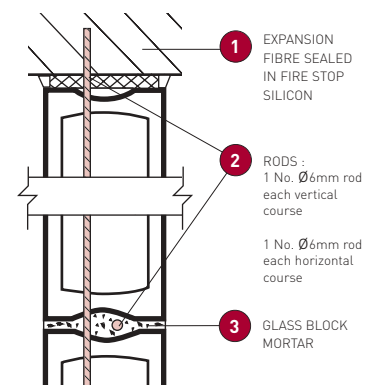
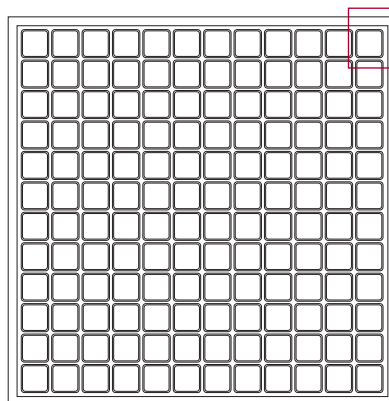



Tél. : 03 84 78 61 00
Fax : 03 84 92 42 10
e-mail : larochere@veanadoo.fr
N° d'identifiant FR 23 815680020

78210 Passavant la Rochère, Fr

V. réf. :
N. réf. :

25/03/99

CSTB FIRE RESISTANCE TEST
(Centre Scientifique des techniques du bâtiment)

Fire resistance:

In France the CSTB (homologation commission) as fire resistance is concerned sets 4 criteria:

- ☐ Resistance to penetration means that the glass must not be broken through by the fire. (verre blanc couleur)
- ☐ Thermal isolation
- ☐ Imperviousness against burning droplets
- ☐ No flammable emission during the test (trique)

All four criteria concern the glass wall which is in direct contact with the test oven.

3 degrees can be obtained from the test:

FIRST DEGREE: [SF] « Stable au feu » Fire stable, means the wall meets at least one parameter.

SECOND DEGREE: [HF] « Pare feu » Fire proof, means the wall meets parameters 1,3 and 4.

THIRD DEGREE: [CF] « Coupe feu » Fire resistant, means the wall has to meet all of the four parameters.

Each degree is given with a time performance: 1/4 hour, 1/2 hour, 1 hour etc...

For instance: A glassblock wall meets all four criteria during 16 minutes gets the classification CF 1/4, does this wall meet only three criteria for 35 minutes than it gets PF 1/4.

90 % of the normal 19x19x8 glassblocks are classified PF 1/4.

LA ROCHÈRE HAS OBTAINED ON:

- 19x19x8 cm CF 1/4 and PF 1hour
- 19x19x10 cm CF 1/4 and PF 1h 1/2

LA ROCHÈRE S.A.
78210 PASSAVANT-LA-ROCHÈRE
SIRET 833 880 010 60014
Tél 03 84 78 61 00 - Fax 03 84 92 42 10

FOR REFERENCE ONLY